

Headshok Lefty Carbon Speed 110 Set Up w/ FOX TerraLogic Inertia-Valve Technology

AIR PRESSURE

RIDER WEIGHT		PRESSURE RANGE ± 10 psi/ 0.7 bar	
lbs	kg	psi	bar
140	64	35	2.4
150	68	40	2.8
160	73	45	3.1
170	77	50	3.4
180	82	60	4.1
190	86	70	4.8
MINIMUM		▶ 20	1.4
MAXIMUM		▶ 120	8.3

REBOUND KNOB

24 Clicks (total)

DIRECTION	DAMPING	SPEED
clockwise +	MORE	SLOWER
counter-clockwise -	LESS	FASTER

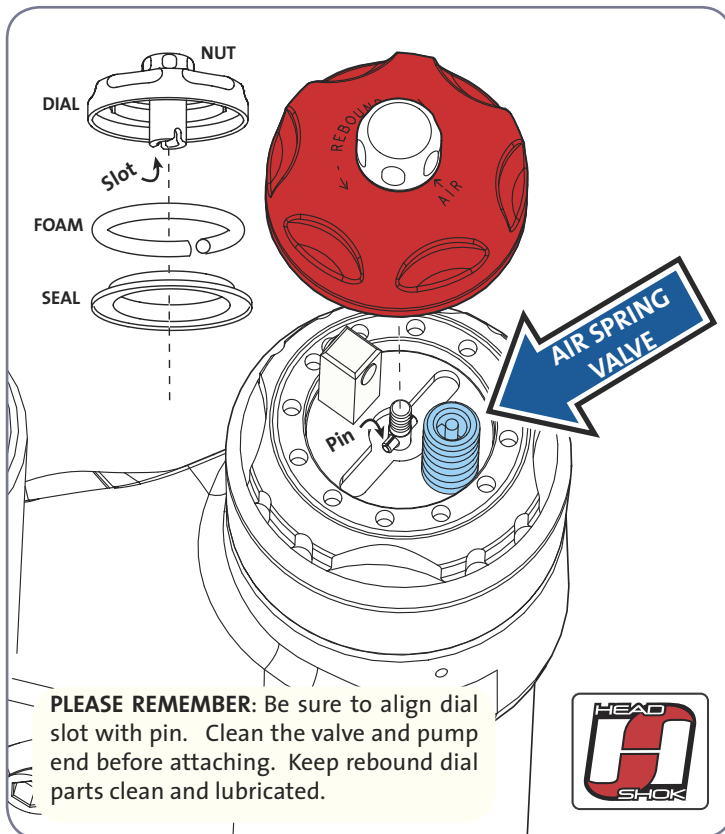

BUMP THRESHOLD KNOB

Adjusts the threshold at which the damper becomes active for a given bump size. Turning the knob in the “+” direction makes the threshold firmer and requires a larger bump to activate the inertia valve.

22 Clicks (total)

DIRECTION	THRESHOLD	SENSITIVITY (TO IMPACTS)	GROUND FORCE (BUMP) NEEDED TO ACTIVATE SHOCK
+	INCREASES	DECREASES	LARGER
-	DECREASES	INCREASES	SMALLER

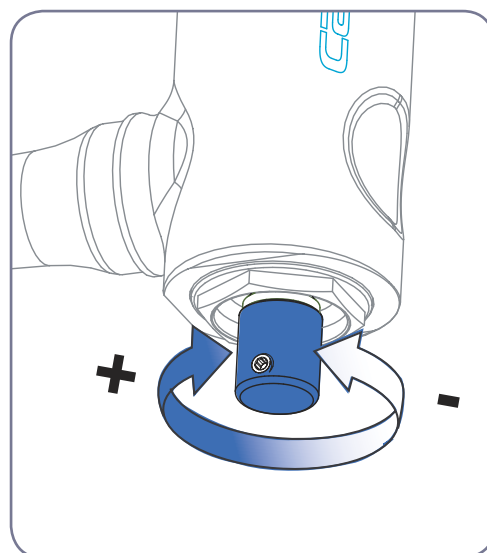

TerraLogic - Inertia-Valve Technology
FOX US PAT NOS 6,581,948 AND 6,135,434

CANNONDALE USA (CUSA)
Cannondale Bicycle Corporation
172 Friendship Road
Bedford, Pennsylvania 15522
(Voice): 1-800-BIKEUSA
(Fax): 814-623-6173
custserv@cannondale.com
URL: <http://www.cannondale.com>

CANNONDALE AUSTRALIA (CA)
Unit 6, 4 Prosperity Parade
Warriewood N.S.W 2102
Australia
Phone (02)9979 5851
Fax(02)9979 5688
cannondaleaustralia@cannondale.com

CANNONDALE JAPAN (CJ)
12-5 Harayamadai
5-cho Sakai City
Osaka, Japan 590-0132
(Voice): 011.81.722.99.9399
(Fax): 0722-93-6166
cjcustserv@cannondale.com

CANNONDALE EUROPE (CE)
mail: Postbus 5100
visits: Hanzepoort 27
7570 GC Oldenzaal
Netherlands
(Voice): +31 541 573580
(Fax): 31-5415-14240
servicedeskeurope@cannondale.com